



ALCATEL

ONE TOUCH
View

English

CONTENTS

<i>PRESENTATION OF THE TELEPHONE</i>	<i>1/</i>
<i>YOUR TELEPHONE</i>	<i>2/</i>
<i>SAFETY AND USE</i>	<i>3/</i>
<i>WARRANTY/ACCESSORIES/INFORMATION</i>	<i>4/</i>
<i>CONVENTIONS USED IN THIS MANUAL</i>	<i>5/</i>
<i>GETTING STARTED</i>	<i>6/</i>
<i>USING DRY CELLS</i>	<i>8/</i>
<i>MAKING A CALL</i>	<i>9/</i>
<i>AN INCOMING CALL</i>	<i>11/</i>
<i>HANDLING TWO CALLS</i>	<i>12/</i>
<i>DIRECTORY</i>	<i>13/</i>
<i>CALL FORWARD KEY</i>	<i>16/</i>
<i>VOICE MAIL AND SHORT MESSAGES</i>	<i>17/</i>
<i>MENU</i>	<i>21/</i>
<i>TIPS</i>	<i>33/</i>
<i>AVAILABLE CHARACTERS</i>	<i>35/</i>

LIST OF ICONS



Battery charge level



Radio signal strength indicator



Mute ringing tone

Icon displayed when the "None" option in "Set Up/Ring tone/Mode" Menu is activated (page 23).



Incoming call unanswered

Icon displayed when a received call is unanswered. It is cleared when you consult ALL unanswered calls displayed with a "!" symbol in the Call memory (page 11).



Unread short message

Icon shows up for a received and unread message. It disappears when ALL messages have been read in FULL, they are displayed with a "!" symbol in the short message list (page 18).



Warning: Message list is full

Your terminal can take no more messages. You must delete one message accessing the list with  (page 20).



Voice mail message received

This icon instructs you to call your voice mail (page 17).



Call forwarding activated by call forwarding key

This icon shows up when a call forwarding has been activated by . It disappears when you deactivate the call forwarding pressing the same key (page 16).



Appointment programmed

This icon shows up when an appointment has been programmed using the "Appointment/To Set" option of the Menu. It automatically disappears when the appointment time scheduled is overrun (page 25).



Terminal connected to a PC

This icon appears when your terminal is connected to a PC via the "PC Card" and ready to receive to send "Data" calls (page 4).

1/ PRESENTATION OF THE TELEPHONE

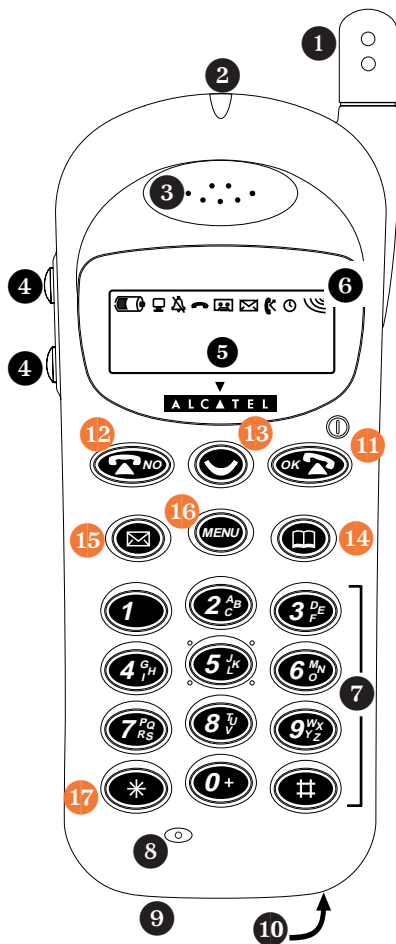

2/ YOUR TELEPHONE

Presentation

- ❶ Antenna
(to be extracted during any call)
- ❷ LED Indicator
 - *Green, blinking: your phone is connected to the network*
 - *Red, blinking on some models only: battery's level of charge is low*
- ❸ Earpiece
- ❹ Volume control
- ❺ Display screen
- ❻ Icons
- ❼ Alphanumeric keypad
- ❽ Microphone
- ❾ Battery charger socket
- ❿ SIM card and battery/dry cells
(on the back of the telephone)

Use

- ⓫ **On/Off**
(keep the key pressed in both cases)
- ⓫ Make a call/**Answer a call**/
Redial
- ⓫ **Hang up**
- ⓫ Lock the keypad
(long keypress)
- ⓫ Return to standby screen
- ⓫ Voice mail
(long keypress)
- ⓫ Directory
- ⓫ Short message
- ⓫ Menu
- ⓫ Call forward key
(long keypress)
- ⓫ Your GSM⁽¹⁾ number/**Help**
(long keypress)

! For exact meaning of the icons ❹, see "LIST OF ICONS".

⁽¹⁾ See "Set up/Numbers" option in the Menu, page 23.

We recommend that you read this chapter carefully before use.

As with all types of radio transceivers, your mobile phone emits electromagnetic waves. This telephone conforms to international regulations insofar as it is used under normal conditions and in accordance with the following instructions.

The manufacturer disclaims any liability for damage which may result as a consequence of improper use or use contrary to the instructions contained herein.

Conditions of use

The retractable antenna must be fully extended. Avoid prolonged contact between the antenna and your skin when the telephone is switched on.

Do not switch on your telephone on board an aircraft, the phone may interfere with the aircraft electronics. Current legislation prohibits this use and can lead to legal proceedings against the user.

Do not switch on your telephone in a hospital, except in areas specified.

Use of the telephone may affect the performance of medical electronic devices (pacemakers, hearing aids, insulin pumps). When the telephone is on, it should not be close to the medical device or in the medical device area. In particular, when you answer a call, make sure you place the phone against the ear that is on the opposite side to the pacemaker or the ear wearing the hearing aid.

Do not switch on your phone near gas or flammable substances.

Strictly obey the rules relating to the use of mobile phones at petrol stations, chemical plants and at all sites where there are explosion hazards.

Do not allow children to use your mobile phone without supervision.

Do not open or attempt to repair your mobile phone yourself.

Only use your phone with dry cells, batteries, battery chargers and accessories recommended by the manufacturer. The manufacturer disclaims any liability for damage caused by use of other chargers or batteries.

Before removing the battery from the phone, make sure that the phone has been switched off.

Environment

Do not expose your phone to unfavourable environmental conditions (rain, dust, sea air, etc.).

Outside the manufacturer's recommended operating temperature range (-20 °C to +55 °C), the legibility of the display may be impaired, but this is temporary and not serious.

Do not attempt to open the battery or dry cells of your telephone, for they contain heavy metals. Do not dispose of used batteries in household rubbish. Dispose of used batteries in accordance with locally applicable environmental legislation.

Safety precautions relating to vehicle use

It is the user's responsibility to check whether local laws permit the use of mobile phones in vehicles.

In case of use in a vehicle and to reduce the effect of electromagnetic waves and interference with the vehicle electronics, the phone should be connected to an external antenna as soon as it is switched on. The antenna must be mounted and located away from passengers or separated from them by a metal screen (e.g. car roof).

Maximum security is achieved when the phone is used in a parked car. However, when the vehicle is in motion and to avoid losing control of your vehicle, we strongly recommend that you use your phone in hands-free mode (see Accessories leaflet).

Use of the phone may interfere with the vehicle's electronic systems such as ABS anti-lock brakes or the airbag. To ensure that there is no problem, please check with your dealer or car manufacturer before connecting your telephone, and avoid in any case placing the phone on the instruments panel.

4/ WARRANTY/ACCESSORIES/INFORMATION

Warranty

We would like to congratulate you for choosing this GSM mobile phone and we hope that the product will satisfy all your needs.

We would like to remind you that this mobile phone has been approved in accordance with European regulations.

Notwithstanding any other applicable statutory warranties, this mobile phone is guaranteed for parts and workmanship for a period of ONE (1) year, from the date of purchase shown on your invoice. Nonetheless, if the statutory warranty in force in your country exceeds twelve (12) months, the statutory warranty will apply in place of the manufacturer's warranty. However, if the statutory warranty does not exceed twelve (12) months, the total warranty period (statutory and contractual) shall be twelve (12) months.

In case of defect, return your mobile phone to your dealer.

This warranty shall not, however, apply in the case of use not conforming with the User's Manual, or in the case of defects due to external causes, or in the case of improper installation, modification or repair performed by parties not authorized by the manufacturer or his dealer.

CE marking indicates that the product complies with EC Directives.

Accessories

The phone is supplied with a battery charger and an uncharged battery. A complete range of accessories complements the standard pack (see "Accessories" leaflet).

The phone can be used to send or receive data to a fax machine or to transfer data if it is connected to a "PC Card" accessory.

⁽¹⁾ With the exception of the batteries which are guaranteed for a period of 3 months.

5/ CONVENTIONS USED IN THIS MANUAL

The following symbols are used throughout this Manual to make it easier to read:



The white hand symbol denotes a **short** keypress.

Example: make a call



LONG KEYPRESS



The greyed out hand denotes a **long** keypress.

LONG KEYPRESS

Switch your phone on



You can use the volume keys to scroll the text until you find the information you need (► cursor).



You can return to the standby screen at any time.



An idea to make life easier



Important information

6/ GETTING STARTED ...

■ Insert the SIM card

The SIM card supplied when you signed up as a subscriber must be "micro" size.

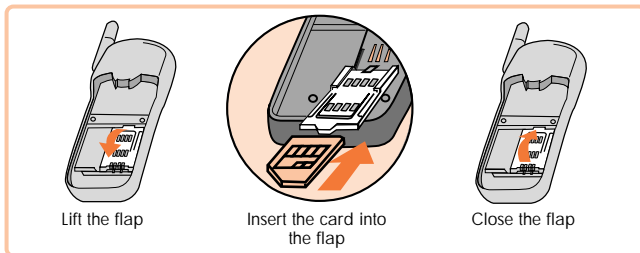

! *Never leave your confidential code near your phone and keep your card somewhere safe when you are not using it.*

■ Install the battery

If you prefer to use dry cells, see relevant paragraph.

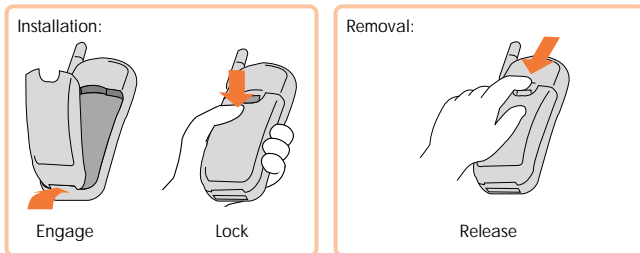

7/ GETTING STARTED

Charge the battery

The battery can be charged regardless whether the phone is switched on or off.

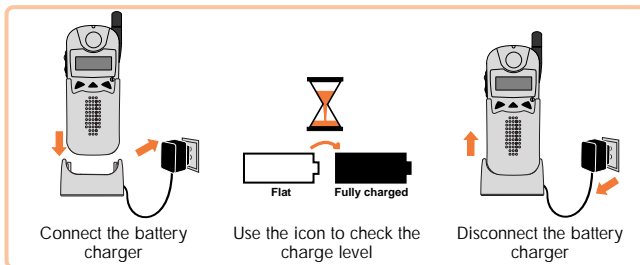

! *If your battery is brand new (or very discharged), recharge it before use: the icon will then appear after a short while. A beep will sound when charging begins.*

The mains socket outlet must be close to the phone and easily accessible.

You can also use the "Set up/Batt. save" option in the Menu.

Switch your phone on

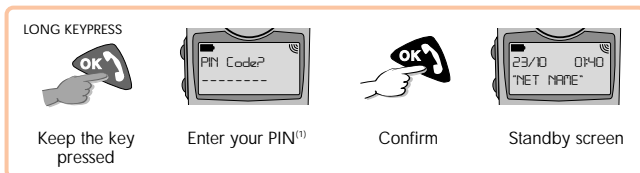

! *While the phone is searching for a network, <<<>>> appears (??? - ??? appears as long as SIM card is not identified by the network).*

💡 *If your battery is new or has been removed, you are asked to enter date and time. Key them in by using the volume keys to switch from one to the other and confirm by .*

⁽¹⁾ *Appearance of this screen and possibility of entering a code depend on subscribed network.*

8/ USING DRY CELLS (Alkaline)

Dry cells will only fit in specially designed batteries. Depending on the battery type, you may use AA (or LR06) type, or AAA (or LR03) type dry cells. In this case, do not use the battery charger supplied.

Remove the battery from the compartment

Dry cells
AA



Shake the compartment and remove
the battery

OR

Dry cells
AAA



Press the holder,
the battery will come out

Fit the dry-cell holder (AA type)

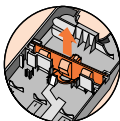

Remove

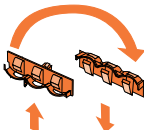

Turn over

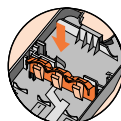

Reposition

Fit the dry-cell holder (AAA type)

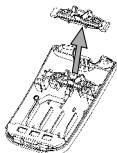

Remove



Turn over



Re-position



Dry cells polarity is marked on the compartment bottom. You may use rechargeable batteries that have been charged OUTSIDE the handset. Never leave dry cells in your phone if it is not used for a prolonged period.

9/ MAKING A CALL ...



Switch your phone on and fully extend the antenna.



Dial the number



Make the call



Talk



Hang up



While dialling you can delete a digit by

LONG KEYPRESS



Making an emergency call: dial 112 then



Making an international call

LONG KEYPRESS



Display the prefix "+"



Access the list of countries



Search for the country



Confirm

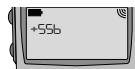

The dialling code is shown on the screen



Dial the rest of the number



Make the call



If you know the called party's complete number, first display the prefix "+" then dial the complete number.

If you want to search for a country by entering the 1st letter of the country name, please see page 14.



Call memory



Access the call memory



Search for number



Make the call

! The last number that was dialled is displayed first (REDIAL function). Your phone can store up to 30 outgoing or incoming calls.

A symbol shows the type of call stored:

- ▶▶ : Outgoing call
- ▶! : Incoming call, unanswered (the  icon goes off when the last unanswered call is read)
- ▶ : Incoming call, answered

LONG KEYPRESS



You can store these numbers in the directory by .

Using your directory⁽¹⁾



Access the directory



Search for person



Make the call

Calling one of your 9 preferred numbers⁽¹⁾

The 9 preferred numbers are the numbers in the first 9 files of your directory. Key in the file number (from 1 to 9), then make the call.

⁽¹⁾ For details on how to program your directory, see the relevant chapter on page 13.

11/ AN INCOMING CALL



An incoming call is indicated by a ringing tone  and flashing of the green indicator LED.



Incoming call...



Answer





Talk



Hang up

 *The calling party's number is displayed if it is transmitted over the network. Contact your network operator to check service availability (Caller ID - Menu, page 32).*

Convenience

To **switch off the ringing tone temporarily** (without losing the call), press  when ringing tone is audible. Then press  to answer the call.



To adjust the **earpiece volume**, use the volume keys.



To interrogate your **answering machine** or **voice mail services**, you can transmit DTMF tones from the keypad during a call.

To **store a telephone number** in the **directory**, simply key in the number and store it by LONG KEYPRESS





To **put an on-going call on hold**, press , confirm the hold, then resume call by .

12/ HANDLING TWO CALLS



 Check whether your subscription entitles you to use this service.

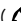

There are two possibilities:

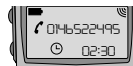
1) You are talking to 01 46 52 24 95 () ,
there is a new incoming call, answer it by  ,

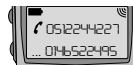

You are talking to 05 12 24 42 27 () ,
01 46 52 24 95 is put on hold (...)

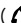

2) You are talking to 01 46 52 24 95 () ,
you want to call 05 12 24 42 27 ,
dial the number, then  ,



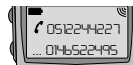

You are talking to 05 12 24 42 27 () ,
01 46 52 24 95 is put on hold (...)



To talk to two people alternately

Swap between the 2 persons by  .

Hang up both calls

Press  to hang up the on-going call, press  to resume the call on hold then press  to hang up that call too.

13/ DIRECTORY ...



Your personal directory can hold up to 250 files (name and corresponding phone number) which are stored in your SIM card⁽¹⁾.

Accessing/exiting the directory



Access directory



Return to standby screen



If your phone is equipped with its removable cover, you can also access the directory by



Creating a file

LONG KEYPRESS



Access directory

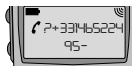

Enter the number
(up to 20 digits)



Store

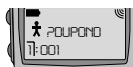

Enter the name
(up to 10 letters)



Store

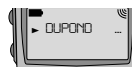

The file is created



See pages 35 and 36 for details on how to key in characters. When keying in data you can delete by

LONG KEYPRESS



or exit by



If you want to use your directory when you are abroad, store your numbers in the international format with the "+" prefix (see page 9).

⁽¹⁾ The capacity of your SIM card depends on your network operator.

14/ DIRECTORY ...



! You can add a sequence of DTMF tones (see page 11) by preceding the number with a pause "P" accessed by . LONG KEYPRESS

Modifying the suggested file number



Access the file number



Enter the new number



Store

💡 The 9 preferred numbers (page 10) correspond to the first 9 file numbers.

Consulting the directory



Access directory



Search for person to call



Make the call

YOU CAN ALSO...

Search by the 1st character of the name

You are in the directory, press "6"
for the letter "M" (see page 35)



Search a file by the file number

From the standby screen, key in the
number of the file you are looking for
and press  to access directory.





Deleting a file

Find the file to be deleted,

access the Delete function
LONG KEYPRESS

by . Press to confirm deletion.



Consulting a file

Find the person to call, consult their

number by . Press to return to the name.



Modifying the details in a file

You are in the file for Martin,

press to access

the Modify function, then press
LONG KEYPRESS

to delete characters

or key in the new details.

Store by .

Same procedure to modify a telephone number.



While entering data you can exit by .



You can forward your calls to the number of your choice.

■ Activating call forwarding

LONG KEYPRESS



Access call forwarding



Dial call forwarding number





Activate



Call forwarding is activated: the  icon appears

■ Cancelling call forwarding

LONG KEYPRESS



Access call forwarding by . With your call forwarding number displayed, press  to cancel it. The  icon disappears when call forwarding is cancelled.



To choose a different type of call forwarding, use the "Forward/Voice/CF key" option in the Menu (page 26).

■ Modifying the call forwarding number

LONG KEYPRESS

With the call forwarding number displayed, you can delete it by . Dial the new number then activate it by .

■ Using your directory



Your call forwarding number is displayed



Access directory



Search for called party



Confirm



The number is updated



Activate

17/ VOICE MAIL AND SHORT MESSAGES ...

The network provides this **voice mail service** to ensure that you do not miss any calls: it works like an answering machine.

Accessing voice mail

LONG KEYPRESS

You can access voice mail by  and then make a call by .

 *If you are asked for a number, dial the number which your network operator supplied.*

For details on how to use this service from abroad, please contact your network operator.

To modify the call number for voice mail, use the "Set Up/Numbers/VoiceMail" option in the Menu (page 23).

18/ VOICE MAIL AND SHORT MESSAGES ...

The network operator's **short message service** allows you to receive or send messages (up to 160 characters) to another GSM phone, fax or other specific servers.

Reading your messages

The indicator LED flashes, the  icon appears and possibly a beep sounds to indicate that a message has been received.

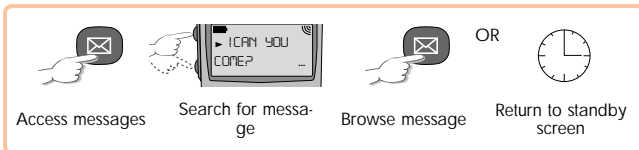

 The last message received is displayed first.



 A symbol indicates the type of message stored:

- ▶ : Message read
- ▶! : Unread message (the  icon goes off when ALL unread messages are read)
- ▶➤ : Outgoing message
- ▶➤• : Outgoing message and acknowledgment receipt correctly received
- ▶➤x : Outgoing message with acknowledgment lost or message not delivered (user must then send again)

Call a telephone number contained in a message

If a message contains a telephone number,

you can store it in the directory by

 LONG KEYPRESS or dial it by .



19/ VOICE MAIL AND SHORT MESSAGES ...

■ Creating and sending a message

Key in the message

LONG KEYPRESS



Create a message

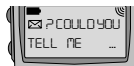

Enter the message
(up to 160 characters)



Store



While entering data you can insert characters (page 35), delete them by

LONG KEYPRESS



or exit by



Select the recipient and send the message



Enter recipient



Store

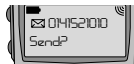

You must confirm



Send the message

OR modify parameters necessary for sending the message



Access parameters

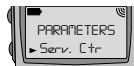

List of parameters
shown on screen



Search for parameter
and confirm



If you wish to request an acknowledgment receipt, or if your message was not delivered, you may access the network necessary parameters to modify them. See modifiable parameters on the following page.



The modifiable parameters are:

Serv. Ctr: Server centre number.

Format: type of message to be sent to your correspondent (fax, pager, email, ...).

Retry Dur: time during which network offers message to your recipient in case of unsuccessful delivery.

Receipt: acknowledgment receipt request.

Deleting a message



Search for message



Access Delete function

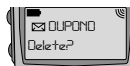

You must confirm

Confirm deletion by or cancel by .

Modifying a message

Find the message, access the page in question by pressing .



Access the Modify function by pressing . Delete by .

LONG KEYPRESS

or insert the new text from the keypad, and, finally, store by pressing .



Accessing/exiting the menu

Access the menu



Return to standby screen to exit menu

Abbreviated menu

Option	Code	Option	Code
Set up	1	Call bars	5
Ring tone	11	Outgoing	51
Time & Date	12	Incoming	52
Display	13	Activated	53
Numbers	14	Messages	6
Beeps	15	CellBroad	61
Languages	16	Sent	62
Batt. save	17	Security	7
Call	18	PIN code	71
Welcome	19	PIN2 code	72
Appointmt.	2	Ntwk. code	73
To set	21	MENU code	74
Cancel?	22	Prod.code	75
Billing	3	Services	8
Duration	31	Networks	81
Cost	32	Call wait	82
Forward.	4	ConcealID	83
Voice	41	Caller ID?	84
Data	42	Call memory	9
Fax	43		
CancelAll	44		

Choosing an option

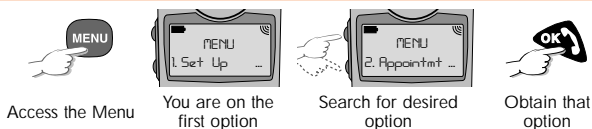

Quitting an option

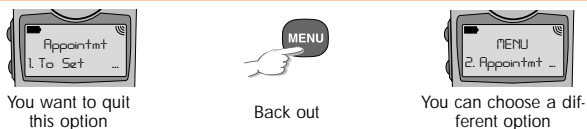

The "... " symbol at the end of a line indicates that there is more information.

Quick search

Please see Abbreviated menu (previous page) in order to identify the code used to access the chosen option directly.

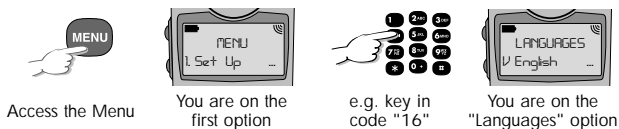

OPTION

CODE

USE

Set up**Set up your telephone to suit you!**

Ring tone	11	Personalise the ringing tone.
Mode	111	"Normal", "Discreet" ring tone ("beeps" emitted before ringing), or "None" (the icon is displayed).
Volume	112	Volume of ringing (use volume keys to adjust).
Melody	113	Melodies (choose one of 15 suggested tones).
Time&Date	12	Reset time.
To set	121	Set your phone to correct time (use volume keys to switch between time and date).
Format	122	Date and time display format.
Display	13	Optimise backlighting.
Backlight	131	Backlighting intensity (use volume keys to adjust). We recommend you choose minimum intensity in order to save battery power.
Contrast	132	Display contrast (use volume keys to adjust).
Numbers	14	Storage of all numbers.
GSM Num.	141	Number of your GSM phone (generally stored in your SIM card).
VoiceMail	142	Number used for your voice mail.
Keypad	143	Direct dial numbers: these numbers can be dialed with a long press on one of "1" - "9" of the keypad, <u>from the standby screen</u> . Example: To programme number "0146522495" under key "2", select option "2 -", validate by , enter calling number (0146522495) then press : the option becomes "2 014652249...".

^(*) Contact your network operator to check service availability.

OPTION	CODE	USE
--------	------	-----

Set up (cont'd)

Beeps	15	Management of "beeps".
Key beeps	151	"Beeps" linked with key presses.
Sht press	1511	Activation/Deactivation
Lng press	1512	Activation/Deactivation
Msg. tone	152	"Beep" on incoming message.
 Languages	 16	 Message display language. The "automatic" option chooses the subscribed network language (if provided by the handset).
 Batt. save	 17	 Battery power saving
Discharge	171	Discharging the rechargeable battery to be carried out on any battery (except Lithium batteries), approximately once per month for optimal performance. Connect the battery charger to initiate discharging which is automatically followed by charging regardless whether the phone is switched on or off. It is advisable to discharge the battery twice in succession in the case of a brand new rechargeable battery.
Power off	172	Automatic phone switch-off if it is not used for a prolonged period (no keypress, call or message is received).
 Call	 18	 Handling calls
Answer	181	Phone goes off-hook automatically after 2 rings approximately ("Automatic"), only by pressing the OK key ("OK key") or by pressing any key ("Any key").
Radiomute	182	Car radio is temporarily switched off while call is in progress (depends on accessory used).
Keyalarm	183	When ignition key is removed leaving phone behind a beep will sound, if function activated (depends on accessory used).

^(*) Contact your network operator to check service availability.

OPTION	CODE	USE
--------	------	-----

Set up (cont'd)

Welcome	19 A welcoming message is displayed each time you switch on: 24 characters are available (available characters, page 35).
----------------------	----	--

Appointmt.2 ***Make an appointment!***

To set	21 Activate date and time of appointment reminder (use volume keys to switch between date and time). The ☹ icon appears. This alarm will sound whether the handset is on or off: pressing any key switches it off.
---------------------	----	---

Cancel?	22 Cancel the alarm: the ☹ icon disappears.
----------------------	----	--

Billing3 ***Keep an eye on your phone bill!***

Duration	31 Management of call durations
Last call	311 Duration of last call
Cumulated	312 Total duration of calls made
Reset	313 Reset total duration of calls
DuratBeep	314 Output "beeps" during a call
Activate/Cancel	3141 Activate (or cancel) "beeps"
Interval	3142 Time interval between 2 "beeps"

Cost^(*)	32 Management of call charges
Last call	321 Cost of last charged call
Credit	322 Remaining credit
Cumulated	323 Total cost of charged calls
MaxCredit	324 Credit limit (beyond which any billable call is barred)
Reset	325 Reset total cost of charged calls

^(*) Contact your network operator to check service availability.

OPTION	CODE	USE
--------	------	-----

Billing (cont'd)

Unit	326	Cost of one Telecom unit in currency of your choice (default list or currency to be keyed in).
Currency	3261	Choice of one of the listed currencies
Other	3262	Enter a non-listed currency
UnitValue	3263	Enter the value of Telecom unit (* for decimal)

Forward.⁽¹⁾**Forward your calls!**

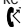
Voice	41	The following options apply to calls (voice)
CF key	411	The selected type of call forwarding is the one accessible directly with a long keypress on the MENU key. Its activation (or deactivation) directly affects the  icon by displaying it (or clearing it).
All calls	412	All call forwarding: all voice calls are forwarded (your telephone gives no warning) to the number specified in the "Number" option.
Activate	4121	Activate this call forwarding
Cancel	4122	Cancel this call forwarding
Status	4123	Interrogate network in order to ascertain call forwarding activation status. We recommend you use this option after any modification is made from your SIM card in a different phone.
Number	4124	Number to which these calls are forwarded.
Conditnl.	413	Conditional call forwarding: your voice calls are forwarded if your line is busy, if you do not answer or if you are out of the network.
Activate	4131	cf. code 4121
Cancel	4132	cf. code 4122
Status	4133	cf. code 4123
Number	4134	cf. code 4124

⁽¹⁾ Contact your network operator to check service availability.

OPTION

CODE

USE

Forward. (cont'd)

If busy	414	Conditional call forwarding: your voice calls are forwarded if your line is busy
Activate	4141	cf. code 4121
Cancel	4142	cf. code 4122
Status	4143	cf. code 4123
Number	4144	cf. code 4124
No reply	415	Conditional call forwarding: your voice calls are forwarded if you do not answer
Activate	4151	cf. code 4121
Cancel	4152	cf. code 4122
Status	4153	cf. code 4123
Number	4154	cf. code 4124
Unreach.	416	Conditional call forwarding: your voice calls are forwarded if you cannot be reached (telephone switched off, out of the network, etc.).
Activate	4161	cf. code 4121
Cancel	4162	cf. code 4122
Status	4163	cf. code 4123
Number	4164	cf. code 4124
Activated	417	List of call forwarding for the voice service is available from this telephone

Data 42 The following options apply to data reception for all calls

Activate	421	cf. code 4121
Cancel	422	cf. code 4122
Status	423	cf. code 4123
Number	424	cf. code 4124

^(*) Contact your network operator to check service availability.

OPTION	CODE	USE
--------	------	-----

Forward. (cont'd)

Fax	43 The following options apply to fax reception for all calls.
Activate	431 cf. code 4121
Cancel	432 cf. code 4122
Status	433 cf. code 4123
Number	434 cf. code 4124

Cancel All	44 Cancel all activated call forwarding
-------------------------	----	--

Call bars⁽¹⁾

5 min

Screen your calls!

Outgoing	51 Criteria barring outgoing calls:
Exc. Dir.	511 Criterion: barring of calls to numbers that are not in the directory
Activate/Cancel	5111 Activate (or cancel) the barring option
All calls	512 Criterion: barring of all calls
Activate	5121 Activate this call barring
Cancel	5122 Cancel this call barring
Status	5123 Interrogate network to ascertain call-screening activation status. If you modified it using your SIM card from another phone it is advisable to always interrogate the network afterwards.
Intl.	513 Criterion: barring of all international calls
Activate	5131 cf. code 5121
Cancel	5132 cf. code 5122
Status	5133 cf. code 5123

⁽¹⁾ Contact your network operator to check service availability.

OPTION	CODE	USE
--------	------	-----

Call bars (cont'd)

Exc.->Home	514	Criterion: barring of all calls except to your country of subscription
Activate	5141	cf. code 5121
Cancel	5142	cf. code 5122
Status	5143	cf. code 5123
Exc. FDN	515	Criterion: barring of calls except pre-stored numbers or prefixes in the SIM card (FDN). Access to this option is protected by PIN2 code (see "Security/PIN 2 code" option).
Activate/Cancel	5151	Activate (or cancel) the barring option
FDN Dir.	5152	Updating of authorized numbers in the (FDN) special directory.

Incoming	52	Criteria barring incoming calls
Exc. Dir.	521	Criterion: reject any call of which number is not included in directory
Activate/Cancel	5211	Activate (or cancel) the barring option
All calls	522	Criterion: reject all calls
Activate	5221	cf. code 5121
Cancel	5222	cf. code 5122
Status	5223	cf. code 5123
If abroad	523	Criterion: reject call when you are abroad
Activate	5231	cf. code 5121
Cancel	5232	cf. code 5122
Status	5233	cf. code 5123

Activated	53	List of call screening operations activated from this phone.
------------------------	----------	--

^(*) Contact your network operator to check service availability.

OPTION

CODE

USE

Messages⁽¹⁾**Exchange messages!**

CellBroad	61	Messages broadcast over the network (weather, traffic, etc.) are automatically displayed on the standby screen (scroll these messages using the volume keys and exit by pressing), provided you have created a list of codes (see option "CellBroad/CB List").
Reception	611	Permanent reception ("Full") or incomplete ("Restricted") of all messages broadcast with network codes specified in the "CB List" option. To save battery life, you must do without permanent reception ("None" option).
CB list	612	Network codes used to monitor broadcast messages (short keypress on OK adds a code, long keypress on NO deletes the selected code).
Sent	62	Operator's preset parameters for short message transmission. They are stored in the SIM card.
Format	621	Message conversion format (fax, e-mail, etc.).
Retry Dur	622	Time during which network offers messages to your recipient in case of unsuccessful delivery.
Serv. Ctr	623	Server centre number (consult your network operator).

⁽¹⁾ Contact your network operator to check service availability.

OPTION	CODE	USE
Security  Protect your phone against fraudulent use!		
PIN code⁽¹⁾	71	This code is checked each time the phone is switched on.
Activate/Cancel ..	711	Activate (or cancel) checking of this code.
Change	712	Update code (4 to 8 digits) after keying in old value.
PIN2 code⁽¹⁾	72	Code which is checked when accessing certain SIM card functions: Billing/Cost and Screening/FDN.
Change	721	cf. code 712
Ntwk. code⁽¹⁾	73	Password (supplied when subscriber signs up), required for network-linked "Barring" options.
MENU code	74	Code which is checked when accessing the MENU (except for Ring tone, Appointment and Set up options).
Activate/Cancel ..	741	cf. code 711
Change	742	cf. code 712
Prod.code	75	Code which is checked before phone is used.
Activate/Cancel ..	751	cf. code 711
Change	752	cf. code 712 (if this code is identical to the PIN, you are not asked to enter it after the PIN).

⁽¹⁾ Contact your network operator to check service availability.

OPTION

CODE

USE

Services***Use the facilities offered by the network!***

Networks	81	Search for a home network.
Srch.Mode	811	Connection is established with the last used network on a priority basis ("Automatic") or with the network chosen by the user ("Manual").
Available	812	Networks available in your radio environment.
Preferred	813	List of networks to which you want to be connected on a priority basis (short keypress on OK adds a network to your list, long keypress on NO deletes selected network).
Call wait⁽¹⁾	82	A second incoming call is indicated by an audible signal.
Activate	821	Activate this option
Cancel	822	Cancel this option
Status	823	Interrogate network to determine option status
ConcealID⁽¹⁾	83	Your calls can be anonymous because your identity is withheld.
Caller ID?⁽¹⁾	84	The other party's number (or name if it is recognised in the directory) is presented with each call.

Call Mem.***Clear call memory***

⁽¹⁾ Contact your network operator to check service availability.

33/ TIPS ...

You want to **keep your phone switched on** while it is in your handbag or briefcase. Lock out the keypad with a long press on . Key in "159" to unlock it.

You **cannot switch** on your phone:

Check your rechargeable battery or dry cells are installed and charged.

You cannot **charge your battery**:

Check that you are not using dry cells and that you connected the battery charger correctly.

The phone fails to **recognise your SIM**:

Check that you did not insert the SIM card the wrong way round.

Your **PIN is rejected**:

You must have made 3 unsuccessful attempts to enter your PIN. Enter the PUK 1 unlock code supplied when you signed up as a subscriber (10 attempts are allowed). If this is unsuccessful, please contact your dealer.

Your **PIN 2 is rejected**:

Proceed as above but use PUK 2 unlock code.

You cannot make a call:

Go to another location because you are probably in an area which is not covered by the network (car park, tunnel, etc.): as long as this situation lasts, chevrons <<<--->>> appear on the screen.

You cannot receive any calls:

If the indicator LED is not flashing, see previous paragraph.

If the indicator LED flashes green you may have:

- switched the ringing tone off (the  icon is then displayed)
- forwarded your calls
- barred certain calls

34/ TIPS

Your rechargeable battery **discharges too quickly**:

The operating time depends significantly on the:

- rechargeable-battery model
- temperature conditions (0 °C to 40 °C is ideal)
- the radio coverage of the network (consult your network operator)
- the speed at which you drive (the phone continuously searches for cells to establish its location).

The empty battery icon () **is flashing**:

Recharge your battery as soon as possible. Its level of charge is becoming too low to guarantee correct operation of the phone.

The indicator LED is **not flashing**:

Go to another location because you are probably in an area which is not covered by the network (car park, tunnel, etc.): as long as this situation lasts chevrons <<-->>> appear on the screen.

The indicator LED **flashes red**, on some models only:

Recharge your battery as soon as possible: its level of charge is becoming too low to guarantee correct operation of the phone.

35/ AVAILABLE CHARACTERS ...

See the presentation of your telephone in order to find your way round the alphanumeric keypad numbered **7** on page 1 more easily.

Each keypad key can be used to access several characters in accordance with the table below:

Key	Number of keypresses							
	1	2	3	4	5	6	7	8
1	1	SP ⁽¹⁾	,	:	@	'	"	;
2 abc	2	A	B	C	Â	Ã	Æ	Ç
3 def	3	D	E	F	É			
4 ghi	4	G	H	I				
5 jkl	5	J	K	L				
6 mno	6	M	N	O	Ñ	Ö	Ø	
7 pqrs	7	P	Q	R	S	ß		
8 tuv	8	T	U	V	Ü			
9 wxyz	9	W	X	Y	Z			
0 +	0	+	-	/	%	£	\$	¥
*	*	• ⁽²⁾	?	¿	!	¡	&	§
#	#	=	()	<	>		

⁽¹⁾ SP : "space" character

⁽²⁾ • : character needed to key in decimals.

36/ AVAILABLE CHARACTERS

Entering a character



Successively press the appropriate key until the required character appears:

Example:    for B.

LONG KEYPRESS

Deleting a character



If you keep the key pressed, several characters will be deleted in succession.

Moving to a character in an input field



Use the volume keys to move to the required character.



This facility is not available if there are 2 input fields on the screen at the same time.



SHORT KEYPRESS LONG KEYPRESS

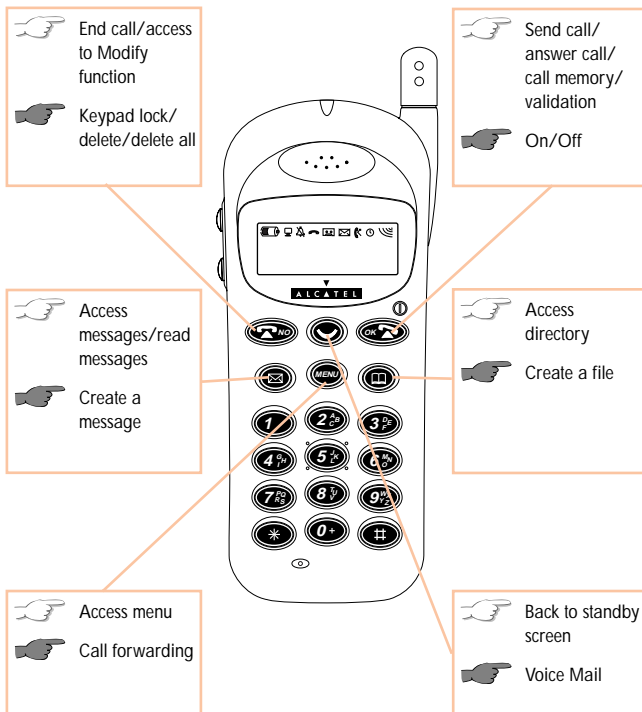

All rights reserved. Alcatel reserves the right, in the customer's interest, to alter material or technical specifications without prior notice.